

# LCD Hour Meter – R8866C

## Specifications



### R8866C

Operating range	99,999.9
Start time	2 seconds
Display	Time Symbol flashes once a second and counts time.
Accuracy	$\pm 0.02\%$
Appearance	No deformation, bubble, flaw or unevenness. Clear lens, well joint.
Operating voltage range	DC9-60V; DC10-80V
Operating temperature range	-40°C to + 85°C
Material	Case: ABS; Lens: PC
Terminals	3/16" faston; Max. 4 pins (optional)
Insulation	Resistance between electriferous parts and outside case is over 100MΩ
LCD Hour meter pass the following test:	
Humidity and high temperature	48 hours test at 55°C Humidity varies from 60% to 95% RH
Alter temperature	Put hour meter in -40°C frig for 2 hours and place it in normal temperature for 2-3 minutes, and then put it in 65°C chamber for 2 hours, and place it in normal temperature for 2-3 minutes again. Repeat the above steps for 5 times and put the hour meter in normal temperature, pressure and humidity for 4 hours, and its operating precision is within 0.1%.
Vibration	According to JB/T7307-94, Item 3.6.3 regulations, test hour meter under vibration at set and swept frequency. After test place meter in normal conditions for 4 hours and its operating precision is within 0.1%.
Shock	According to JB/T7307-94, form-7 regulations, test hour meter in mechanical shock chamber. After test its operating precision is within 0.1%.
Seal	Put hour meter in -30°C frig for 2 hours and place it in normal temperature for 2-3 minutes and place the hour meter in 85°C water at the depth of 15cm, and find no air bubble.
Salt fog	16 hours salt fog test, instrument works well.
EMC test	Test have been carried out on a sample R8866B in accordance with ISO13766-2006; Electromagnetic emission radiated from construction machinery without exceed reference limits; Immunity of construction machinery to electromagnetic radiation and BCI without sensitive phenomena. During the conducted transients, sensitive phenomena is found and can recover normally.

Specifications subject to change without notification.

# LCD Hour Meter – R8866C

## Dimensions



紹興華臻電子有限公司  
SHAOXING HUA ZHEN ELECTRONIC CO., LTD

R8866C

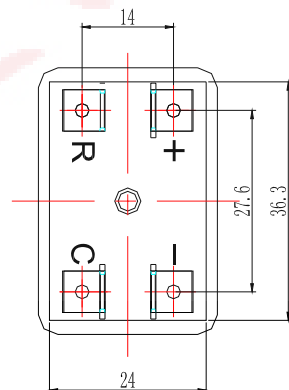
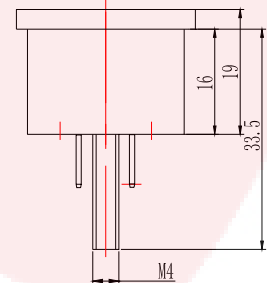
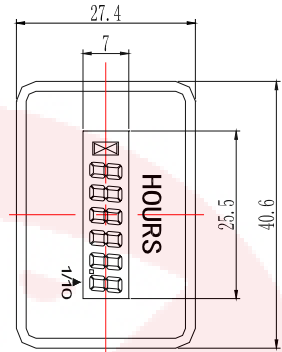

Pin	Function
+	Battery+
-	Battery-
C	Control
R	Reset

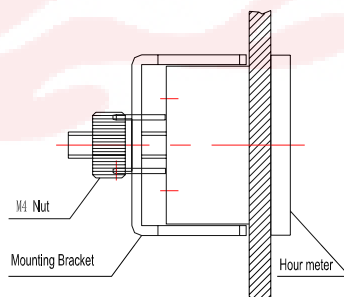
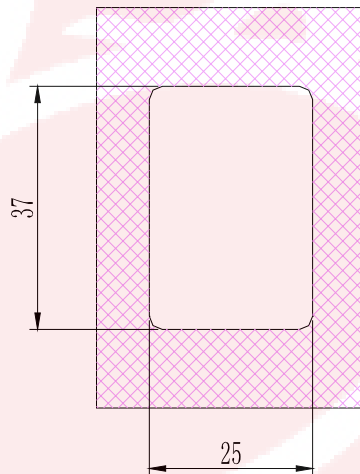

## Technical Specifications

1. Indicating range: 9999.9h.
2. Accuracy:  $\pm 0.2\%$ .
3. EEPROM: retaining data for 25+ years with power off.
4. Terminal: Max. 4: 3/16" spade terminal (Faston included in hardware kit)
5. Self test: when connected to power + & - (Wiring ① & ②). Each digit on LCD shows one second and get ready to count hours.
6. Timing symbol: when counting time (Wiring ③), the sand-glass(time symbol) twinkles at 1 Hz.
7. Reset: pin 4 connected to ground for at least 2 seconds. (Wiring ④)
8. Operating voltage: DC9~60V.
9. Operating amperage:  $< 10\text{mA}$ .
10. Operating temperature:  $-40^{\circ}\text{C} \sim +85^{\circ}\text{C}$ .
11. Comply to: SAE J1378; SAE K1445; JB/T7307-94

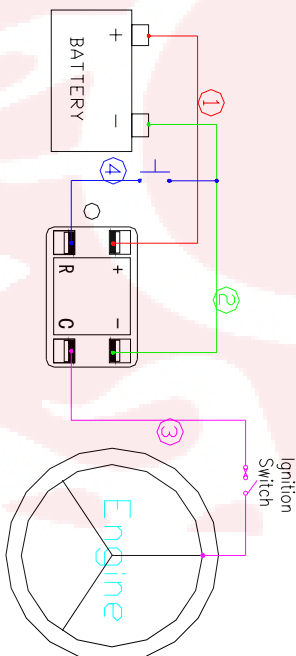

Unspecified tolerance complies with GB/T1804-M

Hour meter R8866C



紹興華臻電子有限公司  
SHAOXING HUA ZHEN ELECTRONIC CO., LTD

图样标记	数量	重量	比例
共 张	第 张		1:1
sales@sxhzelect.com			

# LCD Hour Meter – R8866C

## Optional Functions



R8866-2P



2 pins Hour meter: Hours can't be reset  
+ operating voltage (via ignition switch)  
– common ground

Hour meter shows accumulated hours and counts time as ignition switch turned on.

3 pins Hour meter: Hours can't be reset  
+ operating voltage  
– common ground

→ hour meter shows accumulated hours but not counts time.

C signal input, to engine W

→ Turn on the key enables counting, and time icon flashes @ 1 Hz

4 pins Hour meter: Resettable

+ operating voltage  
– common ground

→ hour meter shows accumulated hours but not counts time.

C signal input, to engine W

→ Turn on the key enables counting, and time icon flashes @ 1 Hz

R reset → Connect to ground for 2 seconds, hour meter resets.